

- NOTES:
1. DRAWING TO BE READ IN CONJUNCTION WITH STRUCTURAL S100 BY OTHER CONSULTANT
  2. REFER TO DWG. A100 & S100 FOR CONSTRUCTION NOTES
  3. FRAMER TO VERIFY ALL BEAM LENGTHS ON-SITE AGAINST AS-BUILT CONDITIONS PRIOR TO FABRICATION
  4. PROVIDE SOUND ATTENUATION BATT INSULATION IN STUD CAVITY FOR SOUNDPROOFING AROUND WALLS IN ALL MECHANICAL, UTILITY, BATHROOMS, AND SUMP ROOM
  5. PROVIDE ACOUSTICAL SEALANT @ TOP & BOTTOM OF WOOD PLATES
  6. ALL FOOTINGS TO BE F2 = 24" WIDE x 10" DEEP C/W 3-15M BOT CONT. U.N.O.
  7. FOUNDATION WALLS TO BE MIN. 10" C/W 10M @ 16" VEF + DWLS. 10M @ 24" HEF + 1-10M HEF ADD'L AT TOP. HOOK HORIZONTAL AT CORNERS C/W 4-15M VERTS ADD'L. PROVIDE CLASS 'B' LAPS. F'C 25MPa CLASS F.2.- TYP.

LEGEND:

- POINT LOAD (REFER TO ROOF TRUSS LAYOUT)
- GIRDER TRUSS (REFER TO ROOF TRUSS LAYOUT)
- \*\* ALL GIRDERS TO HAVE P3 UNLESS NOTED OTHERWISE
- GYPSUM BOARD DROPPED CEILING 8'-11 1/4" FROM T/O GRD. SUBFLOOR

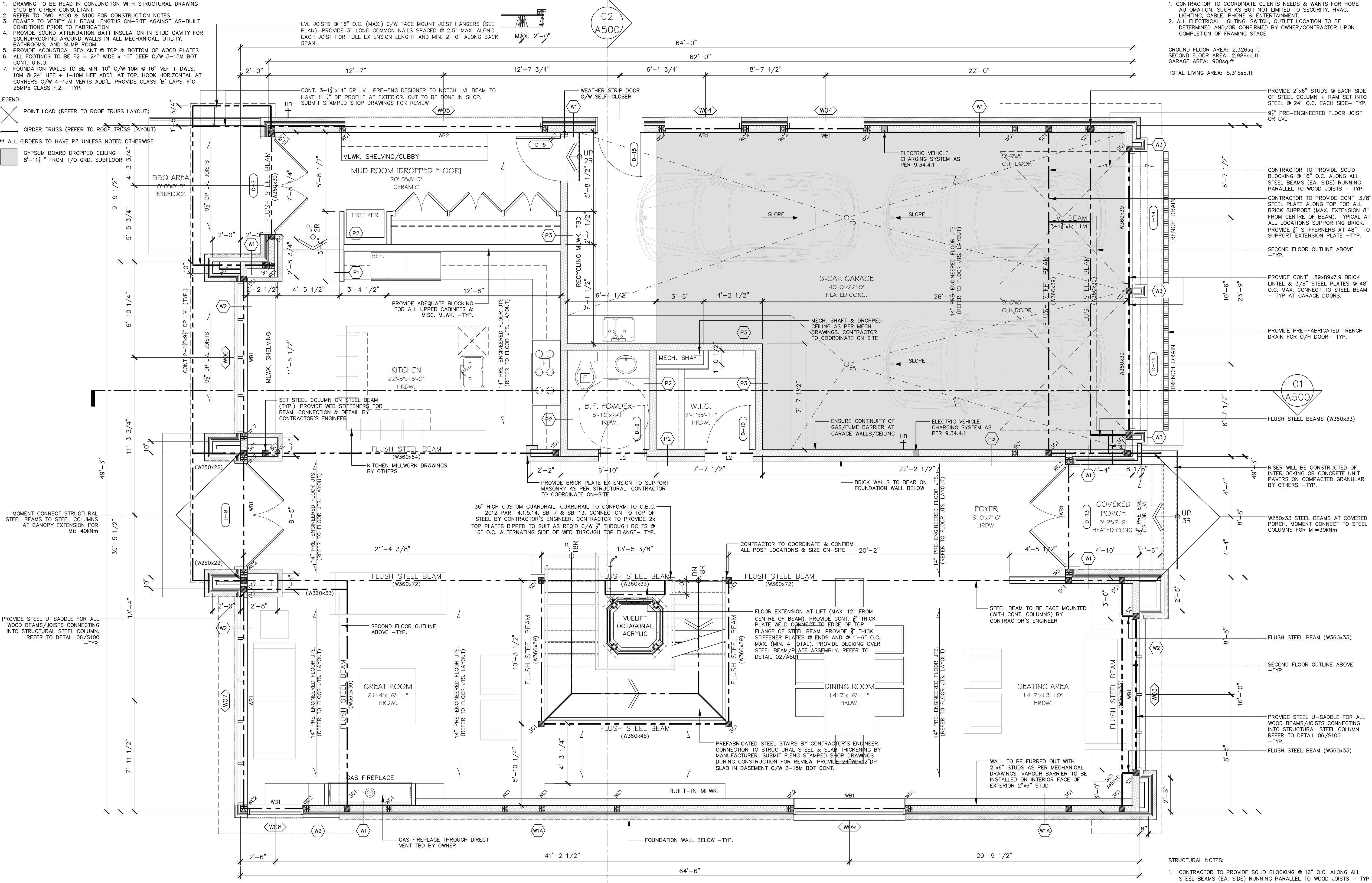

- GENERAL NOTES:
1. CONTRACTOR TO COORDINATE CLIENTS NEEDS & WANTS FOR HOME AUTOMATION, SUCH AS BUT NOT LIMITED TO SECURITY, HVAC, LIGHTING, CABLE, PHONE & ENTERTAINMENT.
  2. ALL ELECTRICAL LIGHTING, SWITCH, OUTLET LOCATION TO BE DETERMINED AND/OR CONFIRMED BY OWNER/CONTRACTOR UPON COMPLETION OF FRAMING STAGE

GROUND FLOOR AREA: 2,326sq.ft  
SECOND FLOOR AREA: 2,989sq.ft  
GARAGE AREA: 900sq.ft  
TOTAL LIVING AREA: 5,315sq.ft

- PROVIDE 2"x6" STUDS @ EACH SIDE OF STEEL COLUMN + RAM SET INTO STEEL @ 24" O.C. EACH SIDE- TYP.
- 9 1/4" PRE-ENGINEERED FLOOR JOIST OR LVL
- CONTRACTOR TO PROVIDE SOLID BLOCKING @ 16" O.C. ALONG ALL STEEL BEAMS (EA. SIDE) RUNNING PARALLEL TO WOOD JOISTS - TYP.
- CONTRACTOR TO PROVIDE CONT' 3/8" STEEL PLATE ALONG TOP FOR ALL BRICK SUPPORT (MAX. EXTENSION 8" FROM CENTRE OF BEAM). TYPICAL AT ALL LOCATIONS SUPPORTING BRICK. PROVIDE 3" STIFFENERS AT 48" TO SUPPORT EXTENSION PLATE - TYP.
- SECOND FLOOR OUTLINE ABOVE - TYP.
- PROVIDE CONT' L89x89x7.9 BRICK LINTEL & 3/8" STEEL PLATES @ 48" O.C. MAX. CONNECT TO STEEL BEAM - TYP AT GARAGE DOORS.
- PROVIDE PRE-FABRICATED TRENCH DRAIN FOR O/H DOOR- TYP.

01  
A500

- FLUSH STEEL BEAMS (W360x33)
- RISER WILL BE CONSTRUCTED OF INTERLOCKING OR CONCRETE UNIT PAVERS ON COMPACTED GRANULAR BY OTHERS - TYP.
- W250x33 STEEL BEAMS AT COVERED PORCH. MOMENT CONNECT TO STEEL COLUMNS FOR Mf=30kNm
- FLUSH STEEL BEAM (W360x33)
- SECOND FLOOR OUTLINE ABOVE - TYP.
- PROVIDE STEEL U-SADDLE FOR ALL WOOD BEAMS/JOISTS CONNECTING INTO STRUCTURAL STEEL COLUMN. REFER TO DETAIL 06/S100 - TYP.
- FLUSH STEEL BEAM (W360x33)

- STRUCTURAL NOTES:
1. CONTRACTOR TO PROVIDE SOLID BLOCKING @ 16" O.C. ALONG ALL STEEL BEAMS (EA. SIDE) RUNNING PARALLEL TO WOOD JOISTS - TYP.
  2. CONTRACTOR TO PROVIDE CONT' 3/8" STEEL PLATE ALONG TOP FOR ALL BRICK SUPPORT (MAX. EXTENSION 8" FROM CENTRE OF BEAM). TYPICAL AT ALL LOCATIONS SUPPORTING BRICK. PROVIDE 3" STIFFENERS AT 48" TO SUPPORT EXTENSION PLATE - TYP.